

STAINLESS STEEL PRECISION PRESSURE FILTER / REGULATOR

PFRSX1-X00 PRSSX1-X00

RELEASED: 12-17-02

REVISED:

(REV. A)

TECHNICAL SPECIFICATIONS

Model Number Series	PXXSX1-X00
Type	PFRSX1-X00 Filter / Regulator PRSSX1-X00 Regulator
Control Range	PXXSX1-200 0 - 60 p.s.i. (0 - 4.14 bar) PXXSX1-400 0 - 30 p.s.i. (0 - 2.07 bar) PXXSX1-500 0 - 100 p.s.i. (0 - 6.90 bar) PXXSX1-600 2 - 150 p.s.i. (0.14 - 10.34 bar)
Port Size (In / Out)	PXXSX21-X00 1/4 - 18 N.P.T.F. PXXSX31-X00 3/8 - 18 N.P.T.F.
Gauge Port Size	1/4 - 18 N.P.T.F.
Filter (models PFRSX1-X00 only)	5 microns

OPERATION CONDITIONS

Maximum Inlet Air Pressure	250 p.s.i.g. (17.2 bar)
Temperature Range	-20° to 180° F (-29° to 82° C)
Application	Industrial compressed air systems

MATERIALS OF CONSTRUCTION

Body	316 Stainless Steel
Filter	316 Stainless Steel
Seals	Fluorocarbon
Diaphragm	Fluorocarbon
Valve	Fluorocarbon

ACCESSORIES

- 104267 - Mounting Bracket
- 104268 - 5 Micron Stainless Steel Filter Element
- 104269 - 40 Micron Stainless Steel Filter Element

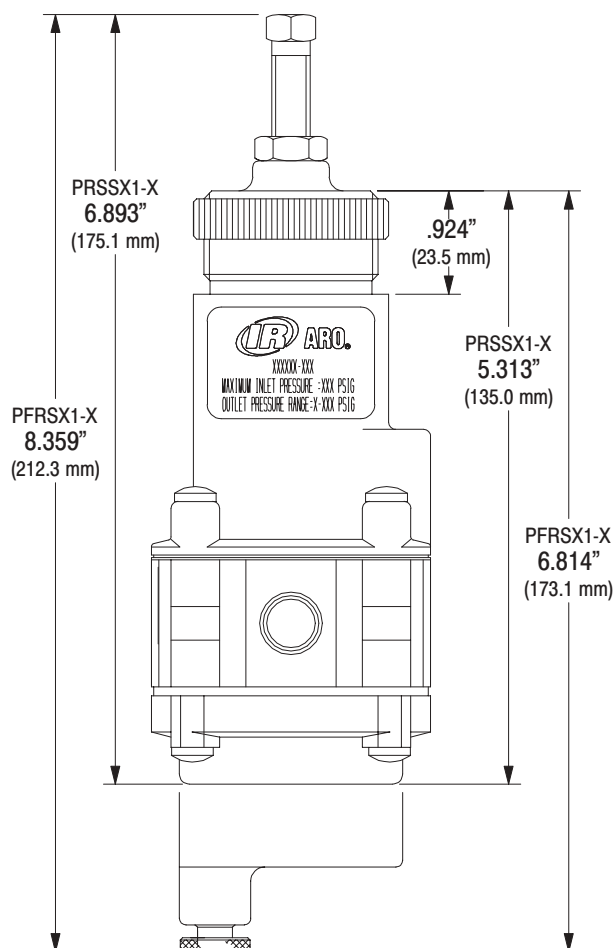
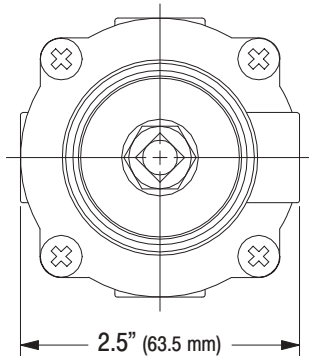

OPERATING AND SAFETY PRECAUTIONS

- Use only genuine ARO replacement parts to assure compatible pressure rating and performance.
- Read carefully all warnings and safety precautions and heed the following before operating, to avoid personal injury and / or property damage.
- Be certain anyone operating this equipment has been trained to use it safely.

⚠ WARNING COMPONENT RUPTURE. DO NOT EXCEED MAXIMUM RATED OPERATING PRESSURE OF 250 p.s.i. (17.2 bar). To avoid possible damage or personal injury, DO NOT expose the unit to excessive pressure beyond the intended working range.

⚠ WARNING TEMPERATURE LIMITS. DO NOT EXCEED MAXI-

MUM TEMPERATURE LIMITS OF 180° F (82° C). Excessive temperature can affect non-metallic parts which may weaken them and cause failure.

⚠ WARNING USE WITH INDUSTRIAL COMPRESSED AIR SYSTEMS ONLY. DO NOT USE WITH BOTTLED GAS PRODUCTS OR FLUIDS. MISAPPLICATIONS CAN RESULT IN COMPONENT FAILURE AND INJURY.

⚠ WARNING DISASSEMBLY HAZARD. DO NOT DISASSEMBLE THIS UNIT WHEN IT IS UNDER PRESSURE. SHUT OFF AND RELIEVE AIR SUPPLY BEFORE ATTEMPTING SERVICE OR DISASSEMBLY PROCEDURES. Isolate the unit by closing the line valve or disconnect the supply line or hose.

INSTALLATION

- Clean out all air lines thoroughly to remove dirt and scale. If the air line contains water, sludge or foreign materials, a filter (5 micron is recommended) should be installed on the upstream side to protect the regulator.
- Install regulator as close as possible to the air operated equipment and upstream from the lubricator for best performance.
- Apply a small amount of compound to the male threads only and install the regulator so that the flow is in accordance with the ports indicated "IN" and "OUT".
- Make sure all connections are tight.
- For panel mounting, the panel mounting nut should be tightened to a torque of 60 in. lbs (6.8 Nm).
- A pressure gauge may be attached to the regulator by removing the gauge port plug.
- After a regulator has been installed in the air line, the adjustment stem should be turned counterclockwise until compression is released from the pressure control spring. This prevents over pressurizing the air operated equipment when the air supply is turned on.

OPERATION

- Turn clockwise to increase pressure.
- Turn counterclockwise to decrease pressure.
- Back off the pressure adjusting stem before putting the regulator into initial operation. Turn on the supply slowly and then turn the adjusting stem until the desired output pressure is reached. It is recommended that the upstream supply pressure be at least 20 p.s.i. more than the regulated pressure.

MAINTENANCE

1. Cleaning of the screen / filter element.
 - A. For models PFRSX1-X00, remove condensation by slowly opening the drain valve and bleeding the accumulated liquid into a container. The liquid will be under pressure; use suitable eye protection.
 - B. Shut off air supply.
 - C. Open the drain valve to relieve all internal pressure.
 - D. Remove 4 screws from the bottom of the unit.
 - E. Remove the bowl and screen / filter.
 - F. Clean all parts thoroughly and reassemble in reverse order. Stainless steel lubricant is recommended for the build screws.